

**Yamato**

# **Checkweigher** *I* series

**INNOVATION IN MOTION**





**INNOVATION IN MOTION**

# Checkweigher I series

## ● INDUSTRY-LEADING PERFORMANCE LEVELS

Speed

**480ppm** (max. 50%UP<sup>\*</sup>)

Accuracy

**±0.15g** (max. 50%UP<sup>\*</sup>)

\*Compared to conventional models

## ● EASY OPERATION

**Auto-tuning**  
for Optimum Control

## ● THE BEST STRUCTURE FOR OPTIMUM FOOD SAFETY & MAINTENANCE

Easy to clean

WATERPROOF

<sup>\*1</sup>  
**IP67, IP69K**

Enhanced Load Cell Protection: 3000N



## ● HIGH RELIABILITY & SAFETY IN USE

<sup>\*1</sup> Reject Confirmation for All-Direction

<sup>\*1</sup> Self Diagnosis, Self Recovery, Optimum Control

\*1: option

# Ensuring the Highest Level of Quality and Safety

## Industry-Leading Performance Level

50% improvement in weighing speed and accuracy (\*Compared to conventional models)

- The new digital load cell does not require auto zeroing due to temperature changes, thus resulting in faster operation.
- The optional dual load cell further increases weighing accuracy.
- The highly responsive load cell stabilizes the products impact with expedience therefore allowing high speed and high accuracy weighing.
- A wider variety of infeed and weighing conveyor sizes maximize speed and accuracy by suiting the specific product being weighed.

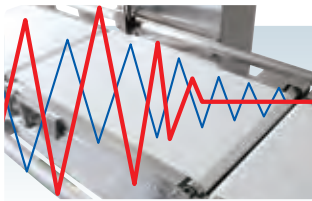

## Easy Operation

- Yamato's original "Automatic program setting system" allows initial settings to be performed without any complicated parameters.
- The new CE3000 indicator utilizes 12.1-inch color touch screen and 3D Animation, thus offering higher visibility and better usability.
- The LED lights located at the top of the indicator can be set to 7 different colors in accordance with the operation, so that the current operational status can be seen from a distance.
- Any operational level on the display can be reached in 3 quick and easy steps.



Automatic program setting display



Operation History Retrieve Function

## Outstanding Food Safety

- I series waterproof models are IP67 compliant. IP69K compliance (optional) enables high pressure and temperature water washing.
- The tubular legs minimize dust accumulation, while the flat design and open-frame structure provide ease of cleaning and a high level of food safety.
- Adopts an anti-bacterial resin.
- Compliant with HACCP and GMP.

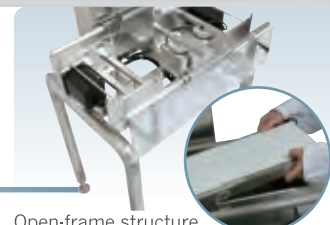

Open-frame structure

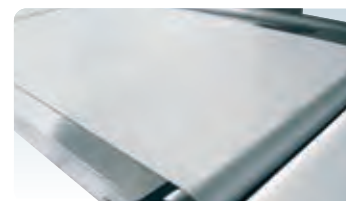

(EU)No10/2011 PIM compliance belt

## Ease of Cleaning & Maintenance

- Parts replacement time alert function  
The indicator shows the time for replacing consumable parts and making maintenance checks. This prevents malfunctions and minimizes downtime.
- The round, bar-shaped stopper enables the load cell to withstand up to 3000N, thus contributing to efficient cleaning, maintenance, and decreasing downtime.
- The error status indication function shows where a malfunction has occurred and how to respond to it, thus enabling quick and appropriate recovery from errors.
- Modularization of parts makes previously complicated repair and maintenance easy.
- Conveyors can be removed and reattached very simply without the need for any special tools.
- Anti-error monitor and alert function (weighing error, photo sensor error, etc.)



Maintenance history display



Error status display



Alert function display



Easy removal of conveyor

## Reliability & Safety

- All-direction reject confirmation (optional)  
By installing sensors in all directions, this function is able to confirm whether defective products are being properly rejected and prevents those products from being passed on to the next line.
- Self diagnosis and countermeasure display function  
Error and abnormal situations, such as overload error, A/D converter error, and countermeasure is shown on the display.
- Check item alert function  
The indicator shows items which need to be checked before starting the daily operation.

## Environmental Responsibility

The Checkweigher I Series reduces power consumption by 30% (\*Compared with a conventional model)

- The 7-color LED light function makes operation without the main screen possible, using only LED light indication.
- The backlight is automatically turned off when the unit is not in operation for a specified period of time.  
The conveyor can also be stopped automatically when the unit is not operated for a period of time in order to save energy.
- Minimizes the environmental impact by reducing the number of components by 10%. \*Compared to conventional models
- Compliant with RoHS



## Features of the Control Panel



12.1-inch color touch screen



Printer (Option)



USB memory port



Making use of cumulative production data

## Overall Versatility Means Lower Cost of Ownership

- On-site height adjustment is possible. The main frame and the legs can be separated easily. A variety of leg lengths enables almost any requirement to be met without major modifications.

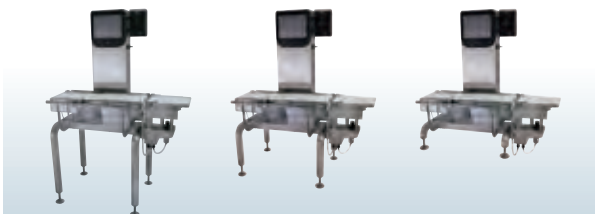

- The compact and flexible design enables the unit to be replaced and to be installed into almost any production line without major modifications.

## Handling Capability

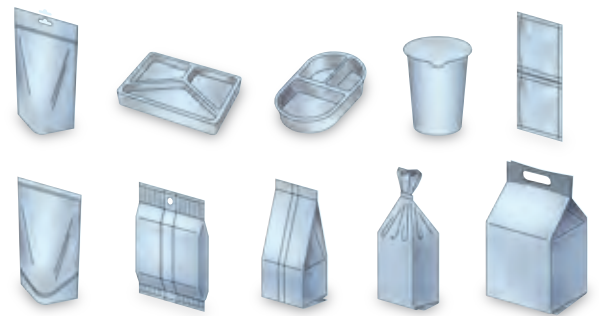

Broad range of packaging

## Options

- IP69K (Factory fitted only)
- Wide Range of Pass Line Height Variations
- Determinate Quantity and Weight Packing Function
- All-Direction Reject Confirmation Function
- Signal Light
- Tri-colored Light
- Printer
- Dual Load Cell
- BCD Product Input
- Feedback Control
- Automatic Conveyor Stop Function (For saving energy)
- Wireless LAN Function
- Data Acquisition
- Wind Cover for Reject Device
- Cover Open Safety Sensor
- RS232C / Ethernet
- External Indicator
- Infeed Guides
- Blue Belt
- BCD Output
- Wind Cover



Wind Cover

## Network Connection Capabilities

The ability to network with peripheral devices improves the production yield rate and saves labor costs.

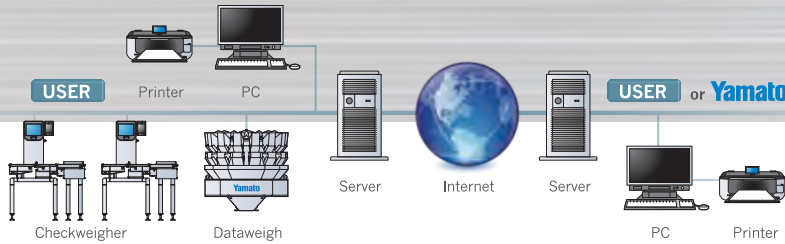

**Operation History Data Retrieval Function**  
After products pass Checkweigher, as well as the weighing value, the resulting operational history data is automatically recorded and transferred to a PC or saved on USB memory. That production output data can be managed centrally and easily utilized for analysis or diagnosis purposes. This function improves traceability and enables the most demanding needs to be met, including customer requests for verification data.

## Feedback Control with Dataweigh™

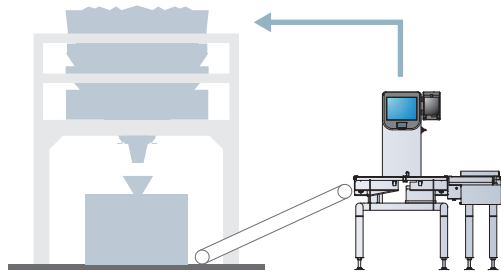

The Dataweigh, multi-head combination weigher, combines the weight of products fed from a number of weigh buckets and delivers a combined weight that is as close as possible to the target weight. Checkweigher then weighs the product and displays the actually measured value. With its feedback control function, Checkweigher sends back the actual weighed value to Dataweigh so that the necessary adjustment in Dataweigh's combined weighing process can be made and the combined weight will be even closer to the target value. This feedback function thus results in better weighing quality, a higher yield rate, and savings in labor costs.

## Net Weight Fill Function

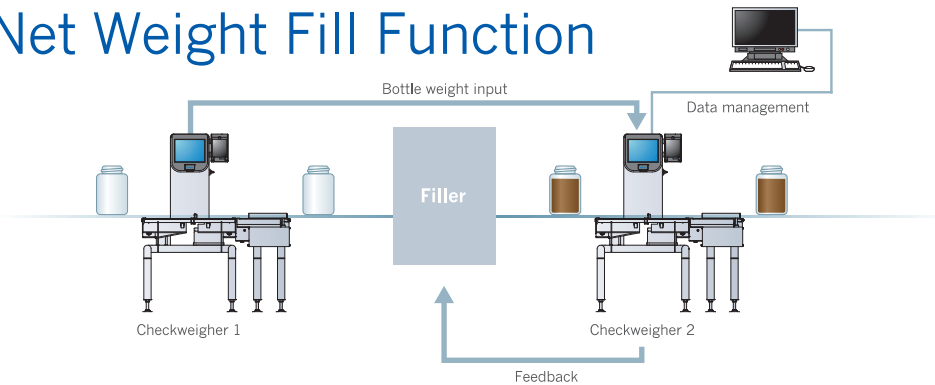

Checkweigher 1 weighs the empty container, then the Filler inserts the contents. Checkweigher 2 weighs the filled container, calculates the net weight, and feeds back that net weight to the Filler for more accurate feeding.

## Reject Device

### Diverter Reject (air / motor powered)

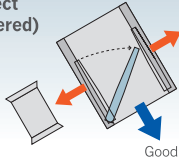

### Air Blast Reject

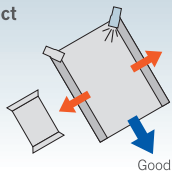

Model	AI21624WI AI2(3)1633WI AI2(3)1644WI	AI2(3)2433WI AI2(3)2444WI
Products size (Max.)		
Width	160mm	240mm
Length	400mm	400mm
Height	160mm	160mm
Weight	300g	300g
Speed (Max.)	400ppm	400ppm
Air supply	0.4 ~ 0.7MPa, 5NL / time	

Model	FI31660WF (Air)	FI31660WFM (H) (Motor)	FI32460WF (T) (Air)	FI32460WFM (H) (Motor)	
Products size (Max.)	Width	160mm	240mm	240mm	
	Length	400mm	400mm	400mm	
	Height	200mm	200mm	200mm	200mm
	Weight	2200g	2200g (1100g)	2200g (3300g)	2200g (1100g)
Speed (Max.)	270ppm	180ppm (220ppm)	200ppm	100ppm (150ppm)	
Air supply	0.4 ~ 0.7MPa, 0.4NL / time		0.4 ~ 0.7MPa, 0.4NL / time	—	

### Driven Drop Flap Reject

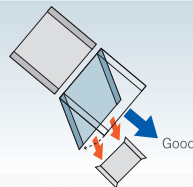

Model	SI21624WF SI21633WF SI21644WF	SI22433WF SI22444WF
Products size (Max.)		
Width	160mm	240mm
Length	400mm	400mm
Height	130mm	130mm
Weight	2200g	3300g
Speed (Max.)	100ppm	100ppm
Air supply	0.4 ~ 0.7MPa, 2.0NL / time	

### Pusher Reject

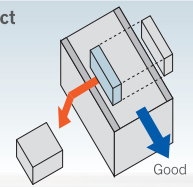

Model	PI21624WF PI21633WF PI21644WF	PI22433WF PI22444WF
Products size (Max.)		
Width	160mm	240mm
Length	400mm	400mm
Height	200mm	200mm
Weight	2200g	3300g
Speed (Max.)	180ppm	160ppm
Air supply	0.4 ~ 0.7MPa, 2.5NL / time	

The specifications shown above are for CSI models. Contact our sales representative for information applicable to CMI model.

## Standard Models

### Specifications

Model	CSI06LW	CSI22LW	CSI33LW		CMI06LW
Range	6~600g	20~2200g	30~3300g		60~6000g
Minimum graduation	0.05g	0.1g	0.1g	0.2g	0.2g
* Accuracy (Max.)	± 0.15g	± 0.3g	± 0.3g	± 0.5g	± 0.5g
Weigh system	Digital load cell				
* Speed (Max.)	480ppm	480ppm	310ppm	190ppm	130ppm
Conveyor variation	Length	240/330/440mm	240/330/440mm	240/330/440mm	400/500/600mm
	Width	160/240mm	160/240mm	240mm	320mm
Belt speed	6 ~ 116m / min		5 ~ 75m / min	5 ~ 76m / min	4 ~ 52m / min
IP protection class	IP67 (Option : IP69K)				
Power supply	AC100 ~ 240V ±10%, 50/60Hz, Single phase, 150VA				
Operating temperature	-10°C ~ 40°C (14°F ~ 104°F)				
Humidity	35 ~ 85% (There should be no condensation.)				
Air supply (Reject device*option)	0.4~0.7MPa	0.4~0.7MPa	0.4~0.7MPa	0.4~0.7MPa	0.4~0.7MPa
Program number	300	300	300	300	300

Design, specifications, and descriptions are subject to change without notice.  
Standard specification is indicated by bold font.

\*Depend on product characteristics.

\*Other conveyor sizes are available. Please contact us for details.



### Dimensions

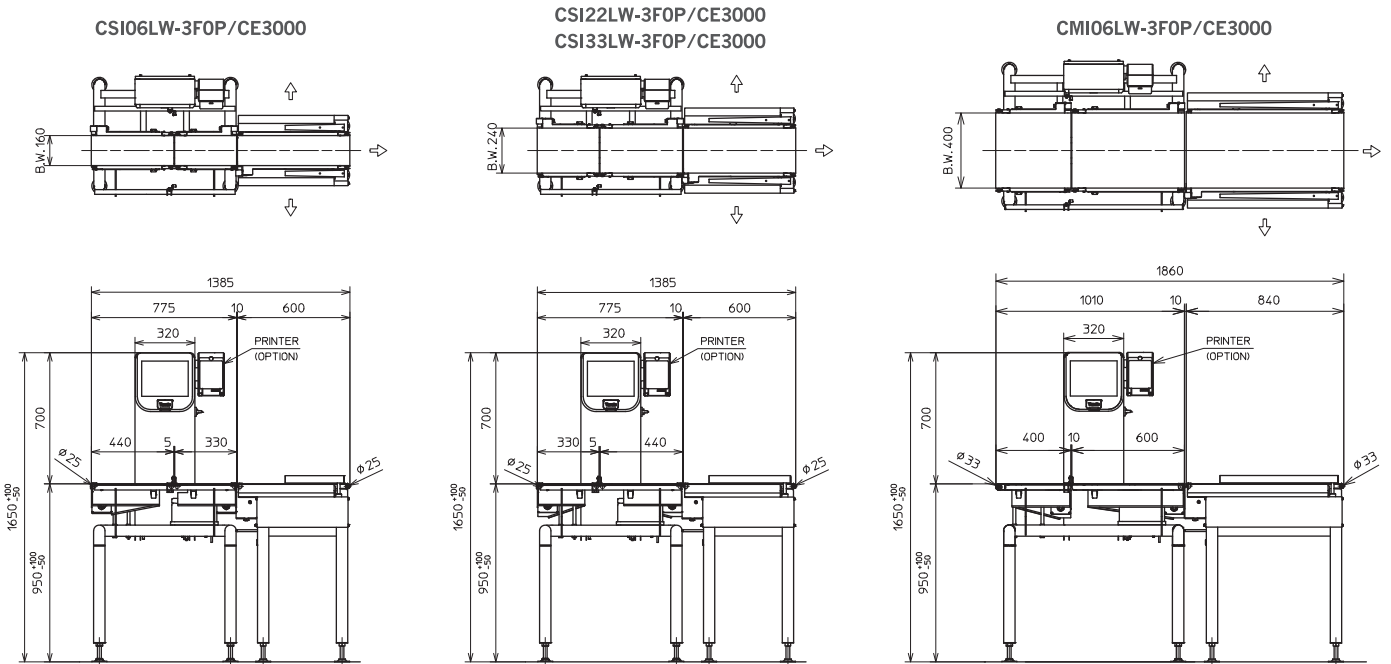

The above system layout is merely an example. Actual layout and dimensions will vary according to the combination of the Infeed Device, Weigh Conveyors and Reject Device. Contact our sales representative for layout and dimensions appropriate to your particular requirements.

# Yamato & the Checkweigher

In 1966, we introduced the Checkweigher CB3. We have supplied high-performance, robust, and user-friendly Checkweigher Series units for about 50 years now, while building up a global customer base over that time. Our headquarters are located in Akashi, Japan, and we have regional offices in the U.S.A., Canada, Germany, the Netherlands, the U.K., France, Russia, China, India, UAE, Mexico, Thailand and Italy. Our worldwide sales network includes representatives in more than 70 countries, and our highly experienced sales and service staff provides customers everywhere with a high level of expertise and service.

## ■ On-site-service

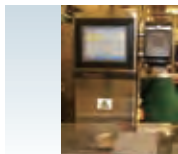

Installation



Application



Training

## ■ In-house-service



Repairs



Maintenance



Helpdesk & hotline

## Worldwide Sales & Service Network

Yamato is the only manufacturer of multihead weighers with wholly owned operations in America, Europe and Asia.

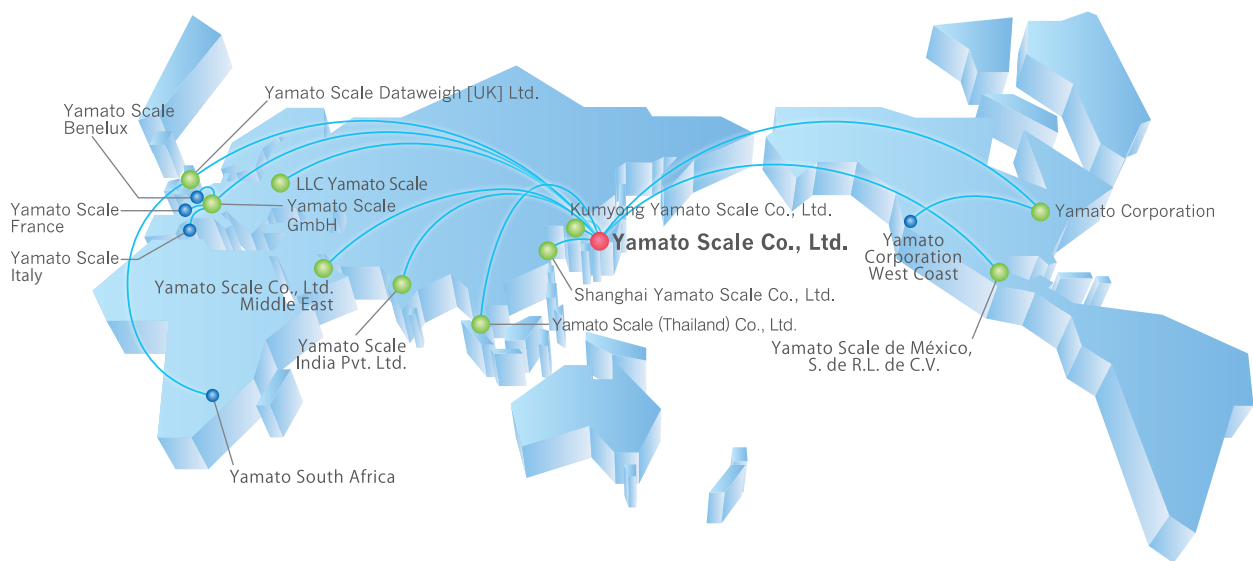

## Spare Parts & Service

Yamato Spare Parts and Service are subject to the same high demands of quality as the machines themselves.

Speed, weight and volume listed are standard. Other ranges are also available when required, please contact Yamato.

This machine is covered by number of patents worldwide. All illustrations and specifications are subject to change without notice.



### Yamato Scale Co., Ltd.

5-22 Saenba-cho, Akashi, Japan 673-8688  
 URL : [www.yamato-scale.co.jp](http://www.yamato-scale.co.jp)

Telephone : +81 78 918-5566-5567-5568  
 Telefax : +81 78 918-5552

### Yamato Corporation

6306 W. Eastwood Court  
 Mequon, WI 53092, U.S.A.  
 Telephone : +1 262 236 0000  
 Telefax : +1 262 236 0036  
 URL : [www.yamatoamericas.com](http://www.yamatoamericas.com)  
 E-mail : [info@yamatoamericas.com](mailto:info@yamatoamericas.com)

### Yamato Corporation West Coast Office

20451 James Bay Circle  
 Lake Forest, CA 92630, U.S.A.  
 Telephone : +1 949 238 4500  
 URL : [www.yamatoamericas.com](http://www.yamatoamericas.com)  
 E-mail : [info@yamatoamericas.com](mailto:info@yamatoamericas.com)

### Yamato Scale de México, S. de R.L. de C.V.

Av. Dr. Gustavo Baz 191, Bodega F  
 Col. El Mirador, CP. 54080, Tlalnepanitla de Baz, Estado de México, México  
 Telephone : +52 55 2628 6140  
 URL : [www.yamatoamericas.com.mx](http://www.yamatoamericas.com.mx)  
 E-mail : [info@yamatoamericas.com.mx](mailto:info@yamatoamericas.com.mx)

### Yamato Scale Dataweigh (UK) Ltd.

Unit 6B, Millennium Way, Leeds, West Yorkshire, LS11 5AL, U.K.  
 Telephone : +44 113 322 1546  
 Telefax : +44 113 350 2020  
 URL : [www.yamatoscale.co.uk](http://www.yamatoscale.co.uk)  
 E-mail : [sales@yamatoscale.co.uk](mailto:sales@yamatoscale.co.uk)

### Yamato Scale GmbH

Hanns-Martin-Schleyer-Str. 13,  
 D-47877 Willich, Germany  
 Telephone : +49 2154 9159-0  
 Telefax : +49 2154 40626  
 URL : [www.yamatoscale.com](http://www.yamatoscale.com)  
 E-mail : [sales@yamatoscale.com](mailto:sales@yamatoscale.com)

### Yamato Scale France

3 Avenue du Canada, Bâtiment Gamma,  
 91940 Les Ulis, France  
 Telephone : +33 1 64 53 24 40  
 Telefax : +33 1 69 07 26 79  
 URL : [www.yamatoscale.fr](http://www.yamatoscale.fr)  
 E-mail : [vente@yamatoscale.com](mailto:vente@yamatoscale.com)

### Yamato Scale Benelux

Edisonstraat 4a, 5051 DS, Goirle,  
 The Netherlands  
 Telephone : +31 13 220 11 17  
 Telefax : +31 13 460 90 81  
 URL : [www.yamatoscale.nl](http://www.yamatoscale.nl)  
[www.yamatoscale.be](http://www.yamatoscale.be)  
 E-mail : [ysb@yamatoscale.com](mailto:ysb@yamatoscale.com)

### Yamato Scale Italy

Via Scirea 5/A  
 43122 Parma, Italia  
 Telephone : +39 521 1475 488  
 Telefax : +39 521 1475 336  
 URL : [www.yamatoscale.it](http://www.yamatoscale.it)  
 E-mail : [sales-it@yamatoscale.com](mailto:sales-it@yamatoscale.com)

### LLC Yamato Scale

Office 50,51,59-65 Building 32A  
 Khoroshevskoe shosse  
 123007 Moscow, Russia  
 Telephone : +7 495 620 4870  
 Telefax : +7 495 620 4877  
 URL : [www.yamatoscale.com](http://www.yamatoscale.com)  
 E-mail : [salesru@yamatoscale.com](mailto:salesru@yamatoscale.com)

### Shanghai Yamato Scale Co., Ltd.

368, Qingda Road, Heqing Industrial Field, Pudong,  
 Shanghai, 201201, China  
 Telephone : +86 21 5897 3377  
 Telefax : +86 21 5897 3377  
 URL : [www.yamatosh.com](http://www.yamatosh.com)

### Yamato Scale India Pvt. Ltd.

B-104, Okhla Industrial Area, Phase-I,  
 New Delhi 110020, India  
 Telephone : +91 11 4607 2882  
 Telefax : +91 11 4607 2881  
 URL : [www.yamatoscale.co.in](http://www.yamatoscale.co.in)  
 E-mail : [info@yamatoscale.co.in](mailto:info@yamatoscale.co.in)

### Yamato Scale (Thailand) Co., Ltd.

88/6 Moo 23, Soi Thidintai, Thepharak Rd.,  
 Bangpleeyai, Bangplee, Samutprakarn 10540, Thailand  
 Telephone : +66 2 136 9773  
 E-mail : [info@yamatoscalethailand.com](mailto:info@yamatoscalethailand.com)

### Yamato Scale Co., Ltd. Middle East (Branch)

Dubai Airport Freezone, UAE  
 LIU-A07, P.O Box : 371911  
 Telephone : +971 4295 2730  
 Telefax : +971 4295 2729  
 E-mail : [yamato@yme-01.ae](mailto:yamato@yme-01.ae)

### Yamato South Africa

Unit 3, 19 Silverstone Crescent,  
 Kyalami Business Park, Kyalami,  
 South Africa  
 Telephone : +27 10 534 8144  
 Telefax : +27 86 572 4403  
 URL : [www.yamatoscale.co.za](http://www.yamatoscale.co.za)  
 E-mail : [salessa@yamatoscale.co.uk](mailto:salessa@yamatoscale.co.uk)